

Building Profile

Alabama Site Selection Database

Scottsboro Aluminum

City: Scottsboro County: Jackson
 Micropolitan Area: Scottsboro



General Building Data	
Total Size	1,050,350 sq.ft.
Space Available	1,050,350 sq.ft.
Multi-tenant	Yes
Building Dimensions	
Number of Buildings	1
Number of Floors	1
Largest Production Area	1,028,359 sq.ft.
Office Area	22,000 sq.ft.
Building Expandable	
Expandable to	
Floor Thickness	
Total Acreage	150
Additional Available	No
Ceiling Height	Eave: 20 ft. Max: 44 ft.
Bay Spacing	Length: Width:
Air Conditioned	
Heated	No
Cranes	Number of Cranes: 10 Capacity of Largest: 150 ton(s) Under Hook: 28 ft.
Truck Docks	
	Dock Level: Drive In:
Year Built	1967
Last Expansion	1967
Refrigerated Area	No
USDA Approved	No
Sprinklers	
Construction Material	Primary: Conc Blk Secondary:
Parking Paved	Yes
Number of Cars	510
Zoning	Light Industrial
Previous Use	Industrial
Previous Use Description	Rolled Aluminum

Building Id: 4305	
Street Address	1762 Goosepond Drive
Nearest City	Scottsboro
Within City Limits	Yes
Zip Code	35769
Latitude	34.59473
Longitude	-86.049274
Located in Industrial Park	No
Park Name	n/a
Within Enterprise Zone	Yes
Within Favored Geographic Area	Yes
Within Renewal Community	No

Transportation	
Rail Service	Provider: Norfolk Southern Track Status: Spur Available Provider #2: Track Status: Not Available
Waterway	Dock Facility: Not Specified
Nearest Commercial Air City	Huntsville, AL Miles to Nearest Service: 50 mile(s)

Highways			
Highway Type	Highway Name	Miles to Access	Four Lane
Interstate	I-24	40	
Interstate	I-565	37	
Interstate	I-59	27	
Federal Highway	72	1	Yes
Alabama Highway	79	1	No

Building Profile

Alabama Site Selection Database

Scottsboro Aluminum

City: Scottsboro County: Jackson
 Micropolitan Area: Scottsboro

Utilities

Natural Gas

Provider: Marshall County Gas District
 Status: Existing
 Size of Main: 12 in.
 Main PSI:

Electricity

Provider(s): Tennessee Valley Authority
 Scottsboro Electric Board
 Status: Existing
 Amps:
 Phase: 3
 Voltage: 13,800

Water

Provider: Scottsboro Water/Sewer &
 Gas
 Status: Existing
 Size of Main: 12 in.

Telecommunications

Service Provider: CenturyLink
 Fiber Optics: Yes
 Redundancy: Yes
 xDSL Available: Yes

Sewer

Provider: Scottsboro Water/Sewer &
 Gas
 Status: Existing
 Size of Main: 8 in.

Price

Base Rent (Annual)	\$1,200,000.00
Base Rent	Total
Sale Price	\$10,000,000.00
	Total
Negotiable	Yes
Date Quoted	Sep 1, 2011
Price Comments	

Key Building Features

There is no existing electrical system in this building, will needs rebuilding. 400,000' area has a 37'ceiling and the long area is 48'. There are large cranes there also. Has its own sewage treatment facility, a large water cooling tower.

General Comments

Building has multiple cranes,including a 150/25 ton double-hook crane in the rolling mill portion(1,950' X 105').Can be divided. 4 rail docks. Floor thickness varies from 10-24.

Building information is current as of 4/28/10

Building Profile

Alabama Site Selection Database

Scottsboro Aluminum

City: Scottsboro County: Jackson
Micropolitan Area: Scottsboro

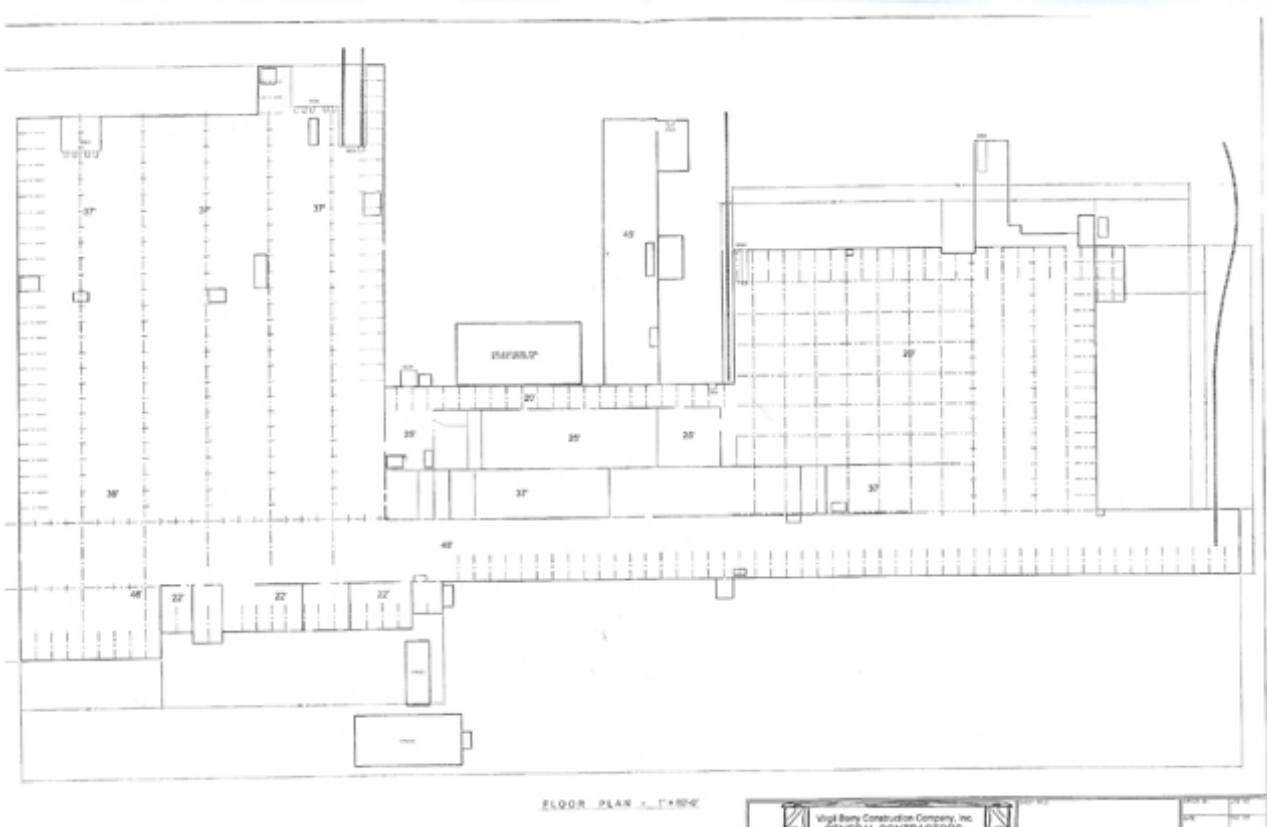

This information has been secured from sources we believe to be reliable; however, we make no representation or warranties, expressed or implied, as to the accuracy of the information.
Economic Development Partnership of Alabama
www.edpa.org

Building Profile

Alabama Site Selection Database

Scottsboro Aluminum

City: Scottsboro County: Jackson
Micropolitan Area: Scottsboro

